

MAJOR OPEN SPACE
(LAKE EDEN/NORTH LAKES
TOWN PARK)

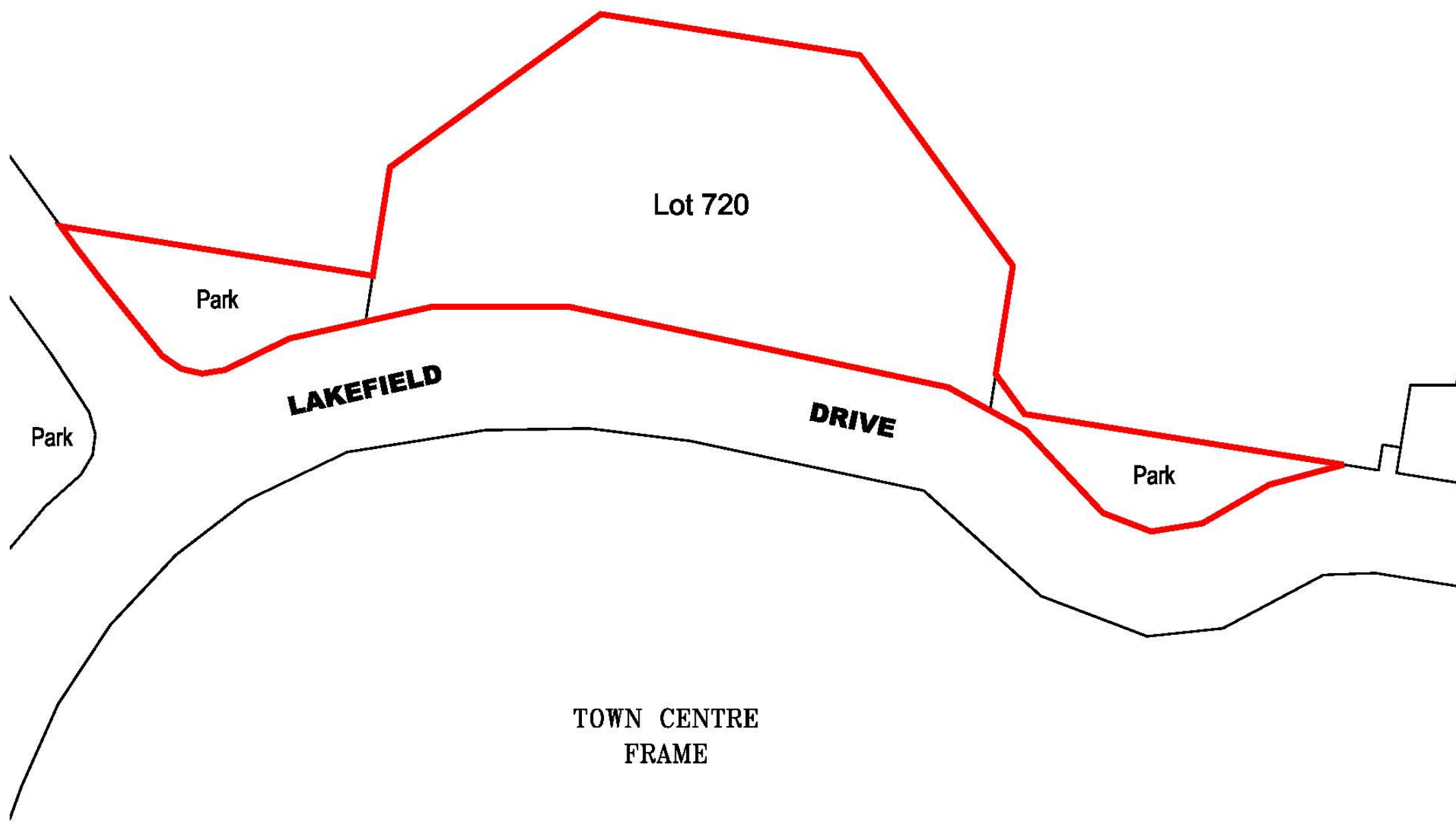

LEGEND

 SECTOR BOUNDARY

* The final lot yield is subject to detailed subdivision and engineering design. A variation in the lot yield will necessitate the submission to Council of an updated Sector Plan Map.

The final areas of each lot will be defined on the plan of survey to be submitted with a Development Application for Reconfiguring a Lot.



LAKESIDE RESIDENTIAL PRECINCT
RESIDENTIAL SECTOR 36

INDICATIVE PLAN OF SUBDIVISION:
MEDIUM DENSITY

0 10 20 30 40 50 metres
Scale 1:1000at A3

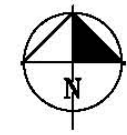

File No 2836-001/11000
Dwg LRsectorfig6A
November 2008