

RETAINING WALL VEGETATION SCREEN ELEVATION

Scale A

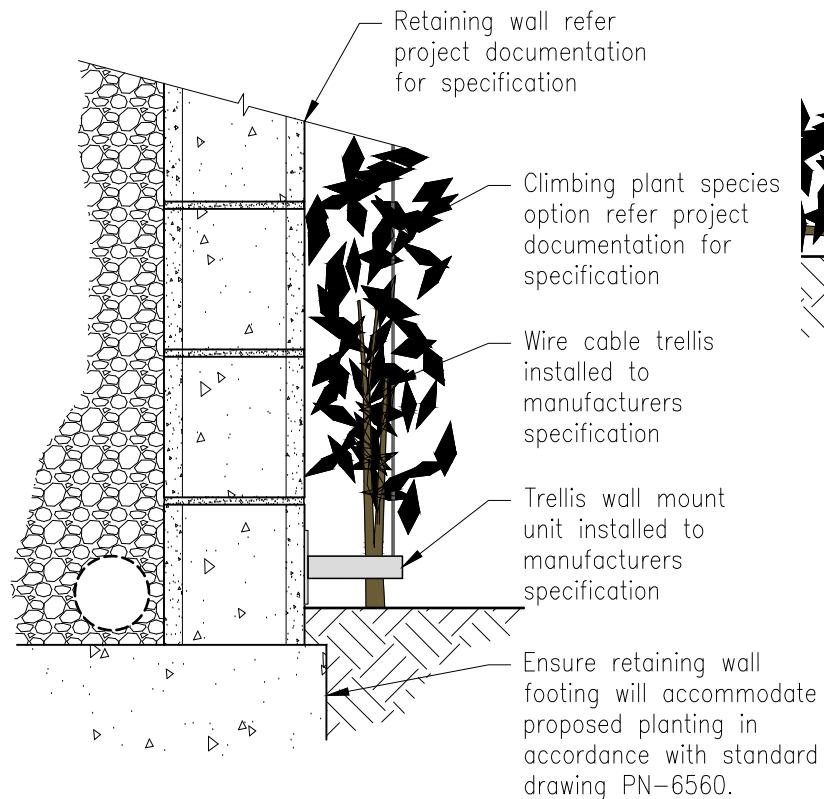

SECTION 1
Scale B

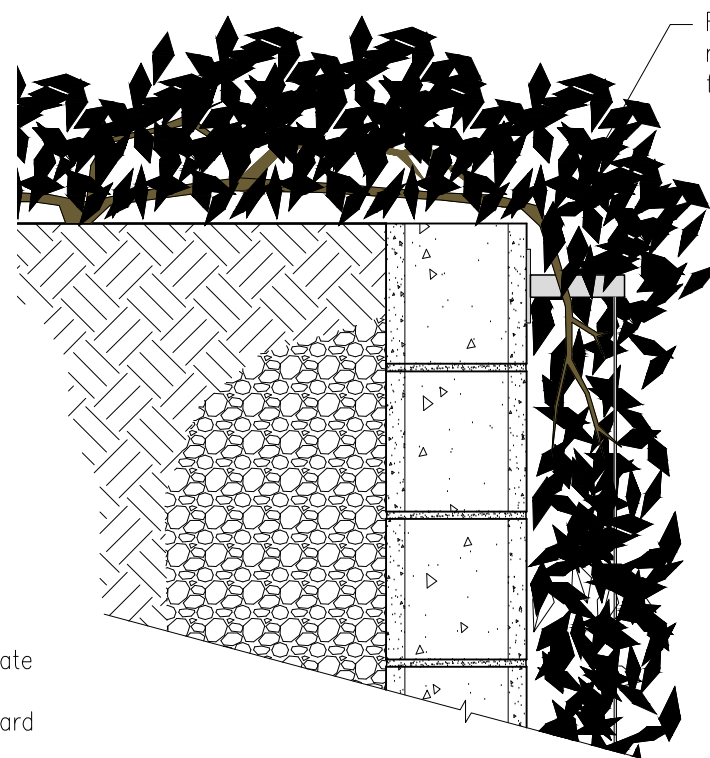

SECTION 2
Scale B

NOTES:

- Selection of the appropriate proprietary trellis system should consider the following site characteristics:
 - Height and length of the wall to be screened including a cost based analysis.
 - Direction the wall faces and consequently what plant species will be suitable for selection.
 - Location, for example a high profile urban location or seaside location would benefit from high end stainless steel components where a less obtrusive situation galvanised steel components may be appropriate.
 - The likelihood of vandalism or theft of the wire trellis.
 - Maintenance implications for the trellis system. Will the system require tensioning and will spare parts be available.
- Consult MBRC Street Tree and Streetscape Design Guideline for additional information. Low maintenance and native species are preferred. The use of mixed species will reduce the risks associated with single species failure.
- Espalier trees and shrubs are also acceptable for vegetation screening to retaining walls.
- The planting site must be significantly de-compacted as vegetation will fail to thrive in compacted ground.
- Refer standard drawing PN-6560 for typical tree planting details.
- All screen components are to be secured to prevent vandalism.
- All MBRC zone codes contain provisions relating to landscaping for retaining walls and structures.
- Design of retaining wall and screen to provide access for maintenance purposes.

REVISIONS	INIT	DATE
E		
D		
C		
B		
A	RH	12/16
ORIGINAL ISSUE	BW	07/16

SCALES	
A	0mm 100 200 300 400 1:20
B	0mm 50 100 150 200 1:10

Drawn	BW	Date	07/16
Coordinator	PP	Date	07/16
AUTHORISED			
SYD JERRAM			
07/07/16			
Manager Integrated Transport Planning & Design RPEQ 6872			

**RETAINING WALLS
VEGETATION SCREEN**

Moreton Bay
Regional Council

DRG No. **SL-1060**

ORIGINAL SIZE **A3** REVISION **A**