

**PLANTING ZONE SCHEDULE**

ZONE	DESCRIPTION	REQUIREMENT
1	0.5m wide strip adjacent pathway	Low growing ground cover
2	Batter slope adjacent pathway	Shrubs and small plants with maximum height 800mm
3	Base planting species	General WSUD planting

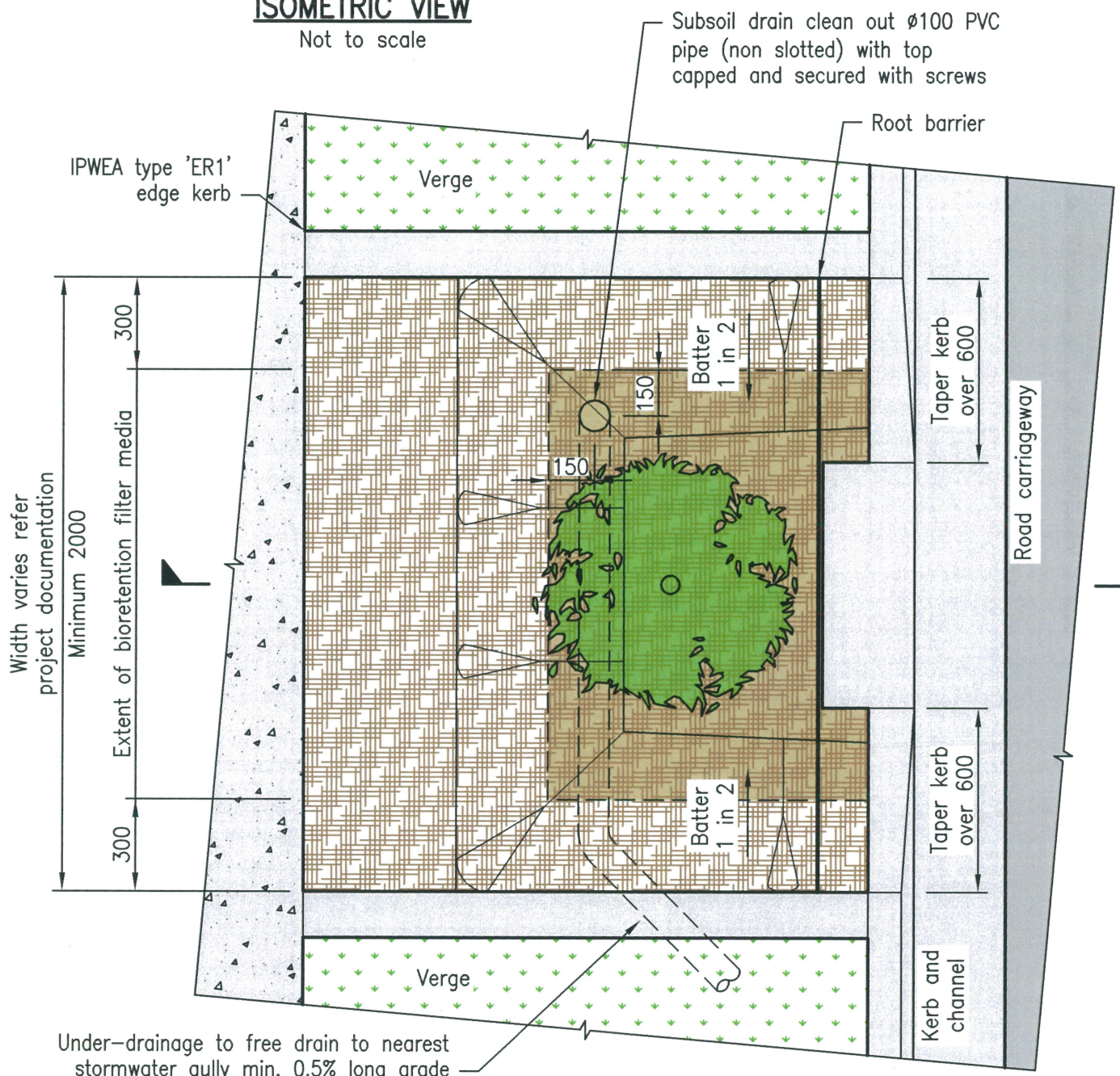
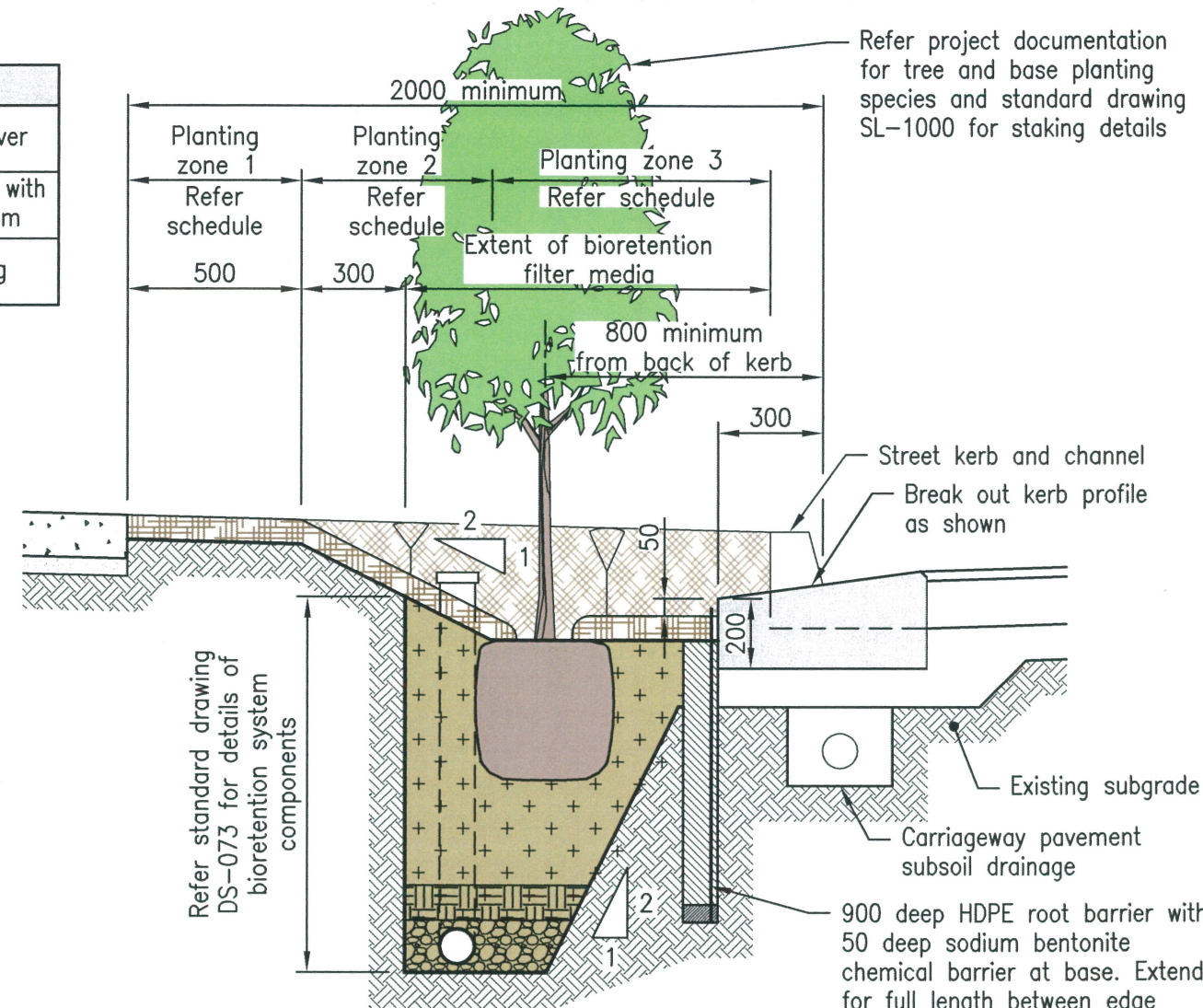
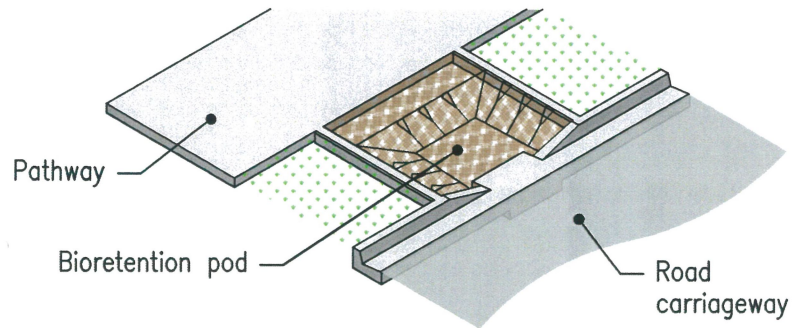

**NOTES:**

1. Detail to be incorporated in developments where services/permits/grades enable the construction of the tree pit and where the under-drain can be connected to gully.
2. Refer to standard drawing DS-073 for notes on filter media, vegetation, under-drains, filter cloth, slotted pipe, general construction and services.
3. The WSUD kerb shown is only suitable for street tree pits and small rain gardens. Larger systems (e.g tree trenches) may need specific inlet design or multiple inlets.
4. Tree pits are to be located upstream of gully pits.
5. If a service (ie gas) will cross the WSUD tree pit, provide a conduit for future use. service size to be confirmed with service provider.
6. If there is a grade up from the road to the footpath, a retaining wall and fence may be required and a tree pit in the verge may be less feasible.
7. Provision of safety and other users shall be in accordance with Austroads requirements such as limiting depth of vertical drops.
8. Maintain 50-100mm radius separation between mulch and stem of tree.
9. Ensure services have been located prior to excavation. Consult with service providers if tree location conflicts with service.
10. Where trees are arranged in sequence provide subsoil drainage clean out at every fifth tree.

REVISIONS		INIT	DATE	SCALES		Drawn	BW	Date	07/16
E				A 0mm 100 200 300 400 1:20		Coordinator	WM	Date	07/16
D						AUTHORISED			
C						 07/07/16 Manager Integrated Transport Planning & Design RPEQ 6872			
B									
A									
ORIGINAL ISSUE		EW	07/16						

**TREE WITH BREAK OUT KERB AND WSUD ELEMENTS**

Moreton Bay Regional Council

DRG No. **SL-1015**

ORIGINAL SIZE **A3** REVISION