

LEGEND

- URBAN RESIDENTIAL-STANDARD AND/OR MEDIUM DENSITY
- VILLAGE PARK (Indicative locations)
- TRANSITION AREA
- INDICATIVE ROAD RESERVE
- INDICATIVE ROAD ACCESS POINTS
- PRECINCT BOUNDARY
- BIOFILTRATION LOCATION
- MAJOR OPEN SPACE - DISTRICT AND LOCAL PLAYING FIELDS
- RETAINED OR REHABILITATED ENVIRONMENTAL CORRIDOR

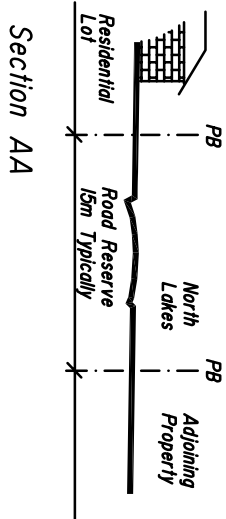
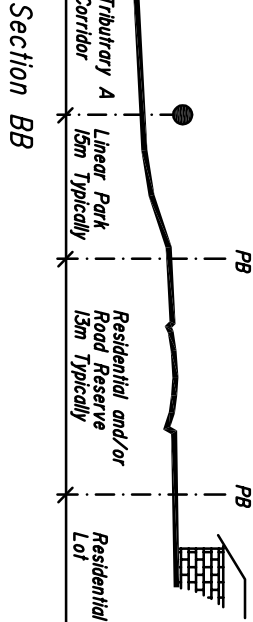

NOTE:

The boundaries of the precinct and the layout and areas of uses are shown in notional terms only. The final boundaries of all land use elements within the precinct area will be fixed upon approval of subsequent sector plans.

Sections are not to scale.

LATM devices to be located on proposed collector road at the southern end of precinct to control through traffic.

NORTHERN RESIDENTIAL EAST PRECINCT

PRECINCT PLAN MAP

Scale 1:2500 at A3

