

## LEGEND

-  URBAN RESIDENTIAL-STANDARD AND/OR MEDIUM DENSITY
-  LINEAR PARK
-  VILLAGE PARK
-  LOCAL PARK
-  INDICATIVE ROAD RESERVE
-  NOISE ATTENUATION AND LANDSCAPE TREATMENT
-  MAJOR ROADS
-  INDICATIVE COLLECTOR STREETS
-  INDICATIVE ROAD ACCESS POINTS
-  INDICATIVE BUS ROUTE OPTIONS
-  MAJOR PATHS
-  GROSS POLLUTANT TRAP
-  STORMWATER FILTRATION WETLANDS
-  VISUAL LINK
-  PRECINCT BOUNDARY
-  THIS WETLAND IS LOCATED WITHIN THE EXISTING NORTH LAKES GOLF COURSE

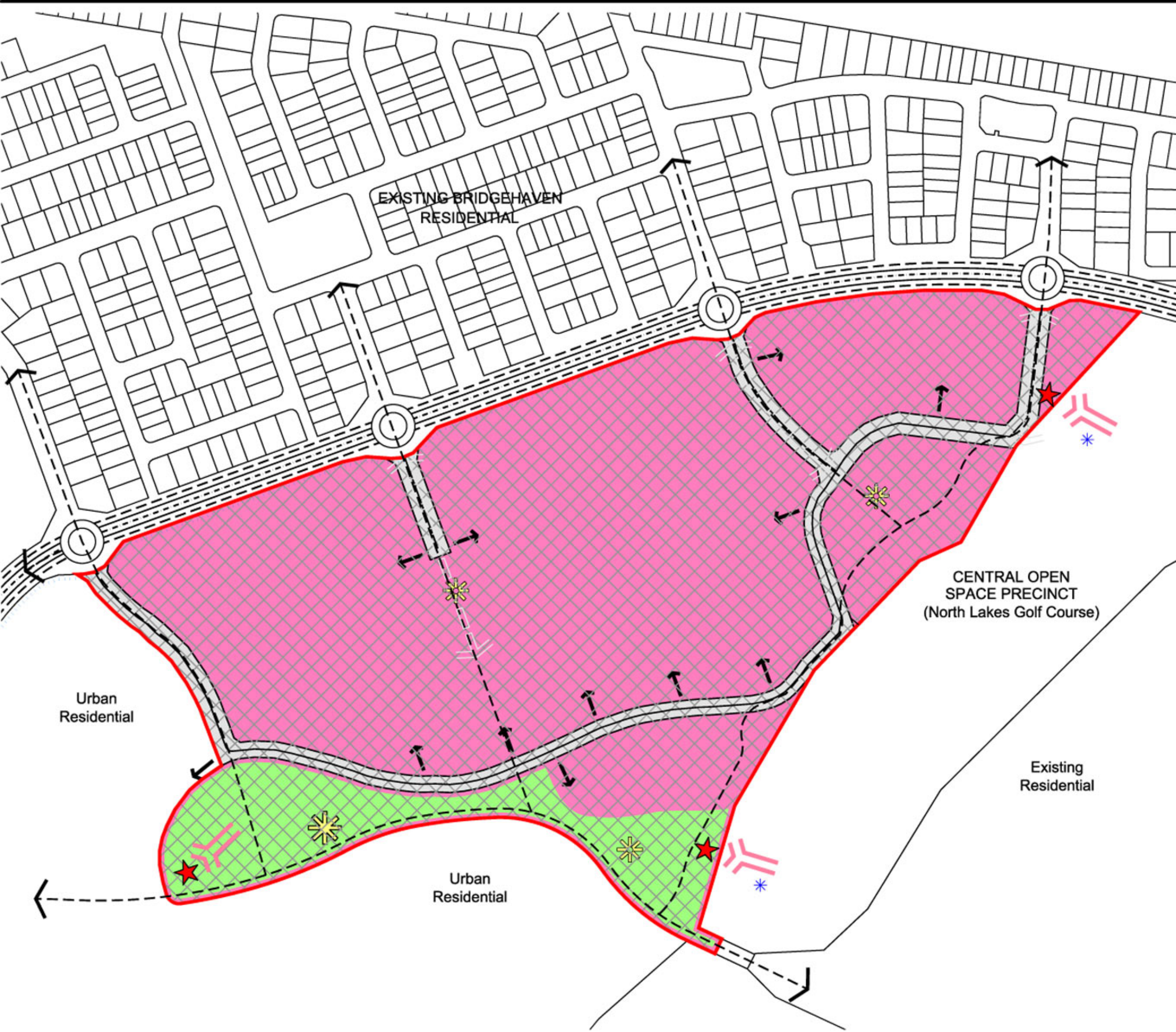

North Golf Course Residential Precinct  
 North Golf Course Residential Sector Two  
**PRECINCT PLAN MAP**

